

INSTRUCTION

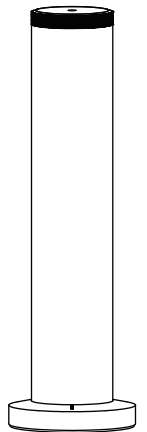

Product instruction manual

Product Introduction

Smart anti-tip aroma diffuser, it will stop working immediately after detecting tipping. It adopts button, Bluetooth dual control and remote control optional to meet the needs of different customers. The high-end all-metal aluminum body highlights the luxurious fragrance atmosphere. The machine can be placed stand-alone, and the fragrance diffusion is accurate and stable, to create different fragrance styles for life. Suitable for sales offices, shopping malls 4S stores, hotels, homes, health centers and other places.

Notice

Please read this instruction manual carefully before using the equipment and keep it in a safe place.

1. Do not use overloaded power sockets, damaged power cables or adapters, otherwise your safety may be endangered. To avoid fire hazards; please replace them in time if found.
2. If you are not a technician, please do not try to modify, disassemble, or repair the equipment to avoid damage to the equipment. If the equipment is abnormal, please check whether it is operated according to normal usage requirements or follow the troubleshooting instructions. If the problem cannot be solved, please contact sales in time.
3. The equipment must not be inverted or tilted when in use. If the equipment needs to be transported to other locations, please maintain and clean the equipment first (see Equipment Maintenance for details) before packaging and transporting , avoiding essential oil penetration and damage to the equipment.
4. Please maintain and clean the equipment regularly to ensure that the equipment is in optimal working condition.

Instructions for refilling essential oil

1. Before refilling essential oils, stop the device for 2 minutes, and unscrew the essential oil bottle after the essential oil flows back inside the atomizer head.
2. It is recommended to control the amount of essential oil added within 45 days each time to avoid deterioration of essential oils due to oxidation.Control panel.

Product parameters

Dimension	Φ92*303.5(mm)
Capacity	110ml
N.W	0.82KG
Coverage	300m³
Voltage	Type-C 5V-2A
Power	8W
Noise	≤38dB
Packaging size	W395*D113*H117(mm)
battery capacity	5000mAh
Smart dumping sensor: When the machine tilts >45°, the buzzer will sound three times and the machine will stop working.	

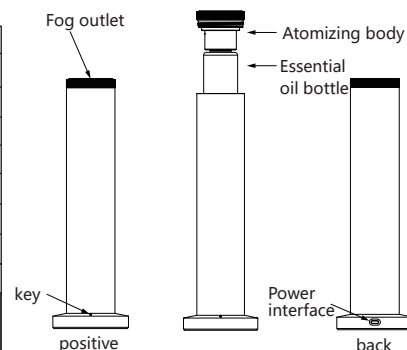

Parts

Name	Power cord	Product manual	Atomizer core	Flat washer
Thumbnail				

Precautions for use

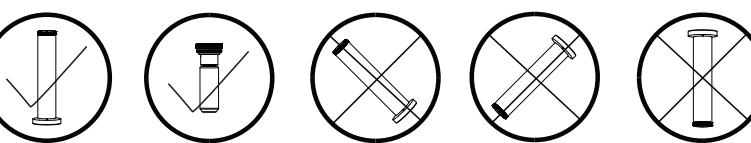

Bluetooth version control instructions

1.Operation introduction:

- ①. Click the button, the buzzer will sound, Switch on/off show always BLUE light, working state. 1st gear (work 30s: pause 300s,24H); 2nd gear (work 60s: pause 60s,24H); 3th gear (work 300s: pause 60s,24H).

- ②. Click the button switch gears, switching between the 1st , 2nd ,3th, shutdown and 1st gear , the buzzer will sound 1-2-3 times accordingly.

- ③. Bluetooth mode can be connected in any state. Please refer to the Bluetooth manuals for App usage.

1.Attention:

- ①. In the Bluetooth connection mode, the machine will beep once after a successful operation.
- ②. When the device is low on power, the red light stays on. It flashes blue light when charging and the blue light stays on when fully charged.
- ③. In working state, the device tilts more than 45° in any direction, the buzzer will sound 3 times and the air pump will stop working.

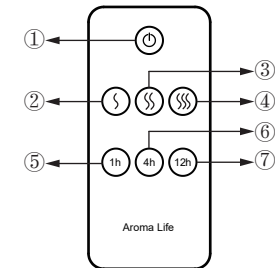
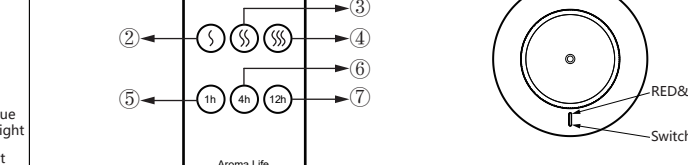

2.Operating introduction

- ① Remote control version, click to turn on the device,the buzzer sounds once, the device switch light is steady BLUE, and the device enters the 1st gear working mode.
- ② When the remote control version changes the gear position and time, the buzzer will sounds once.
- ③ When the device is low on power, the red light stays on. It flashes blue light when charging and the blue light stays on when fully charged.
- ④ In working state, the device tilts more than 45° in any direction, the buzzer will sound 3 times and the air pump will stop working.

Remote version control introduction

1.Remote face panel introduction

- ① Switch: The device switch.
- ② 1st gear: work 30 second : pause 300 second, 1 hour
- ③ 2nd gear: work 60 second : pause 60 second, 1 hour
- ④ 3rd gear: work 300 second : pause 60 second, 1 hour
- ⑤ 1 hour : Gear position works for 1 hour.
- ⑥ 4 hours: Gear position works for 4 hours.
- ⑦ 12 hours: Gear position works for 12 hours.

Installation guide

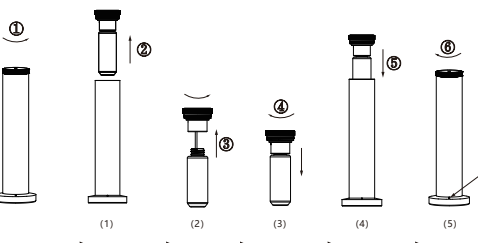

- 1.Rotate the atomizer counterclockwise ①, lift up the atomizer and essential oil bottle, and take out the atomizer and essential oil bottle②.
- 2.Hold the essential oil bottle and turn it counterclockwise to take out the essential oil bottle to separate it from the atomizer, and fill it with essential oil (110ml, the upper limit)③ .
- 3.Rotate clockwise the essential oil bottle back to the atomizer tightly④.
- 4.Put the essential oil bottle and the atomizer into the machine, and tighten it clockwise(no need to correct the direction)⑤.
- 5.Click the switch and start using the device⑥.

Equipment maintenance

In order to ensure the best fragrance diffusion effect, please check and maintain the equipment every six months. When a new fragrance needs to be replaced or the fragrance diffusion effect is weakened, the equipment should also be maintained:

1. Unscrew the used essential oil bottle.
2. Pour an appropriate amount of alcohol into the essential oil bottle and clean it.
3. After cleaning, pour a small amount of alcohol, install the essential oil bottle on the equipment, and turn on the equipment for 5 to 8 minutes.
4. After cleaning the equipment, turn off the power.

Warranty card

This warranty card is a quality guarantee and must be filled out truthfully.

Warranty card 1		Warranty card 2	
Warranty date		Warranty date	
Fault description		Fault description	
Verification date		Verification date	
Maintenance results		Maintenance results	
Maintenance personnel signature		Maintenance personnel signature	

Troubleshooting

Before preparing to repair the equipment, please first try to solve the following problems according to the following methods.

Problem	Solution	Problem	Solution
Equipment does not work	<ul style="list-style-type: none">- Please check if the power adapter is USB 5V-2A and if the Type-C end and USB end are properly inserted.- The working program set by the equipment, whether it is currently in working time	Oil leakage	<ul style="list-style-type: none">- Are the essential oil bottle and the atomizer head tightened- Is the atomizer head seal deformed or damaged- Is the atomizer head damaged
No atomization, small atomization	<ul style="list-style-type: none">- Is the air pump working, and whether there is airflow at the mist outlet- Are the atomizer core and oil suction pipe loose or blocked- Is the air nozzle seal damaged and detached	Abnormal noise	<ul style="list-style-type: none">- The air pump is loose, re-fix the air pump.- The air pump is damaged, replaced with a new one.

After-sales service

The equipment is under warranty for one year from the date of sale and shipment, but the outer shell, power supply, wire and external sealing ring and other wearing parts are not covered. Damage caused by human or accident is also not covered by the warranty. Paid repairs are implemented beyond the free warranty period. If you encounter any after-sales problems, please contact the authorized sales service providers in each region, or contact our company's sales center.